



Freestanding washing machine
Capacity 5.5 kg. (1/10)
Spin 250 to 1250 rpm
Standard frequency inverter controlled
Microprocessor with 10 programs Micro-20/C

HW55

Boiler Fed
Electrical heating 3 kW (220 V -Single phase 220V 50/60Hz)
4,2kW & 6kW (220V & 380V)

Capacity 5.5 kg./cycle

IPSO HW55

Volume drum 55 l.
Spin 1250 rpm
Out of unbalance detection
Micro-20/C controls with 10 standard washing programs.
Gravity drain valve with large diameter
2 inlet valves (hot - cold water)
2 soap compartments + 1 softner compartment on top
Frontal loading
Electro-magnetical locking device for the door
Door opening : 300 mm
Tub and cylinder are made of stainless steel
Emergency button in the front
Dimensions (HxWxD) :1005x660x575 mm.

Micro-20/C Microprocessor

10 standard programs, preprogrammed at IPSO.
Posibility to add on programs up to 100 programs.
Standard frequency controlled motor, it is possible to programme the following parameters :

- Cycle time (Prewash, mainwash, rinse, spin, tumble...)
- Rotation and stop speeds programmable from 0,1 till 60s
- Water level programmable per cm.
- Control of 2 drain valves (second valve in option) with possibility to recycle rinse water.
- Connection up to 6 pumps controlled by Micro-20



for 60 Hz only



IPSO

- an LSG company

IPSO HW55

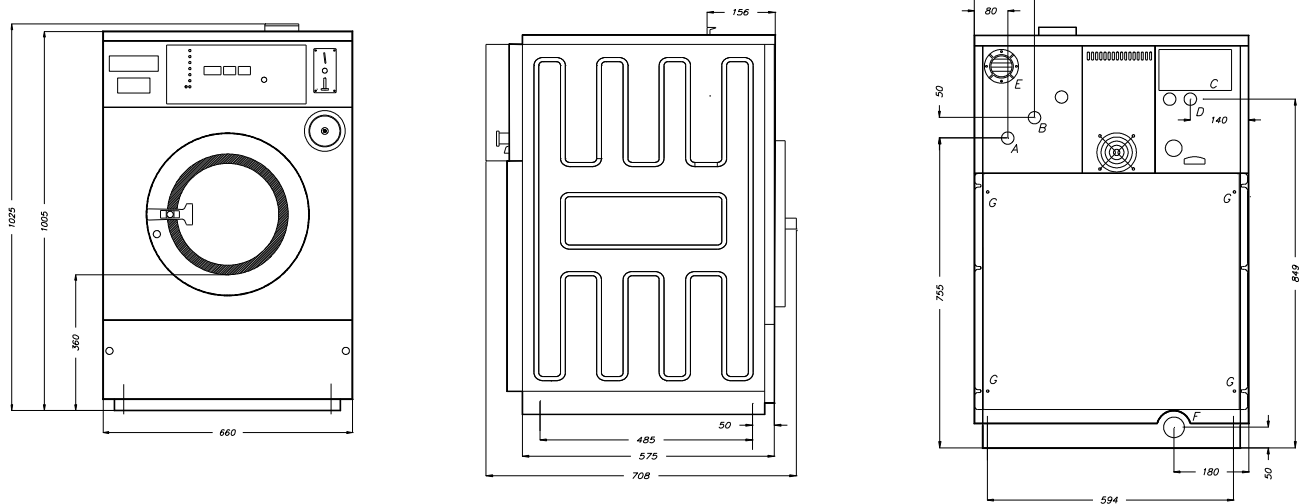

- A. Cold water connection 3/4" E. Ventilation
 B. Warm water connection 3/4" F. Drain valve
 C. Electrical connection G. Bolt pattern for fixation of the machine
 D. Electrical connection clamps H. Emergency button

Cylinder : Volume	55L
Diameter	530 mm
Depth	250 mm
Perforations diam	3 mm
Door opening diam	300 mm
Height to door handle	505 mm
Speed : Spin	250-1250 rpm
Distribution	85 rpm
Wash	10-50 rpm
G-force	18/462
Kinetic energy of the cylinder	1568 N
Dynamic bottom load	600 N / 16 Hz

Power motor	550W
Water pressure	3 to 5 bars
Hot water T° (boiler fed)	80°C
Warm water need (boiler fed machine)	46L/cycle
Diam. drain	50 mm
Drain by gravity	80L/min .
Weight gross /nett	183/169 kg.
Packing dimensions	Height 1140 mm
	Width 740 mm
	Depth 840 mm

All specifications subject to change without notice

Type of heating	POWER SUPPLY - FUSES		
	220V 50/60Hz	230V 3 AC	400V 3 AC+N
Boiler Fed	16 A		
Electrical heating 3kW	16 A		
Electrical heating 4,2kW		16A	16A
Electrical heating 6 kW		16A	16A

Optional: - drain-pump
 - transfo for different voltages

IPSO HW55eng.doc 2002-07-15

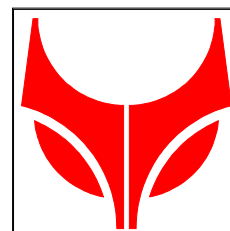

IPSO

- an LSG company

IPSO LSG n.v.
 Nieuwstraat 146
 B-8560 WEVELGEM
 BELGIUM – EUROPE
 Phone ++32 56 41 20 54
 Fax ++32 56 41 86 74
<http://www.ipso.be>





Freestanding washing machine
Capacity 6.5 kg. (1/10)
High spin 500 to 1000 rpm
Standard frequency inverter controlled
Microprocessor with 10 programs Micro-20
Or
Programmable Microprocessor PS 40

HW64

Boiler Fed
Electrical heating 4.2-6-9 kW (220-380 V)

Steam heating

Consumption 6.5 kg./cycle

IPSO HW64

Volume drum 65 l.
 High spin 1000 rpm
 Safety unbalance detection with controlled repetition
 Micro-20 controls with 10 standard washing programs.
 Optional : Freely programmable computer PS 40
 10 standard washing programs + 40 freely programmable programs
 Gravity drain valve with large diameter
 3 inlet valves (hot soft/cold soft/hard water)
 2 soap compartments + 1 softner compartment on top
 Frontal loading
 Electro-magnetical locking device for the door
 Door opening : 300 mm
 Tub, cylinder and cabinet are made of stainless steel
 Emergency button in the front
 Dimensions (HxWxD) :1005x660x730 mm.

Micro-20 Microprocessor

10 standard programs, preprogrammed at IPSO.
 Possibility to add on programs up to 100 programs.
 Standard frequency controlled motor and with the optional soap pumps, it is possible to programme the following parameters :

- Cycle time (Prewash, mainwash, rinse, spin, tumble...)
- Rotation and stop speeds programmable from 0,1 till 60s
- Water level programmable per cm.
- Control of 2 drain valves (second valve in option) with possibility to recycle rinse water.
- Connection up to 6 pumps controlled by Micro-20

Programmable Microprocessor PS40

Possibility to compose 40 programs + 10 standard programs, preprogrammed at IPSO.
 Programs immediately programmable on the machine or with the computer.
 Programs transmissible from computer to machine and the other way around with infra-red cable connection.
 In combination with the frequency controlled motor and the soap pumps (option), it is possible to programme the following parameters :

- Cycle time (Prewash, mainwash, rinse, spin, tumble...)
- Rotation and stop speeds programmable from 0,1 till 60s
- Water level programmable per cm.
- Control of 2 drain valves (second valve in option) with possibility to recycle rinse water.
- Connection up to 12 pumps controlled by PS40



IPSO

-an LSG company



for 60 Hz only

IPSO HW64

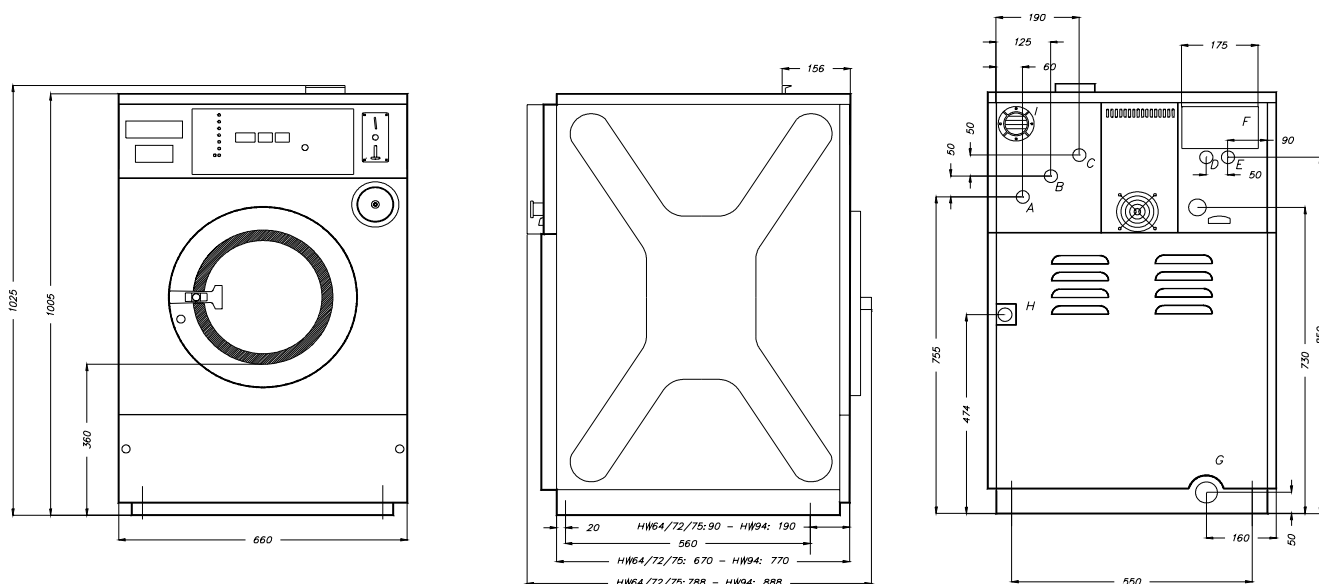

- A. Soft water connection 3/4"
- B. Warm water connection 3/4"
- C. Hard water connection 3/4"

- D. Electrical connection
- E. Electrical connection clamps
- G. Drain valve
- H. Steam connection

Cylinder : Volume	65L
Diameter	530 mm
Depth	295 mm
Perforations diam	3 mm
Door opening diam	300 mm
Height to door handle	505 mm
Speed : High spin	500-1000 rpm
Low spin	250-500 rpm
Distribution	85 rpm
Wash	10-50 rpm
G-force	74/296
Kinetic energy of the cylinder	1186 N
Dynamic bottom load	600 N / 16 Hz

Energy consumption (mot/heating)*	0.15 / 1.5 kW
Power motor	750W
Water pressure	3 to 5 bars
Hot water T° (boiler fed)	80°C
Max. water consumption *	72 L
Warm water need (boiler fed machine)	55L/cycle
Diam. drain	50 mm
Drain by gravity	80L/min .
Steam pressure	6 to 10 kg.
Weight gross /nett	222/200 kg.
Packing dimensions Height	1140 mm
Width	740 mm
Depth	840 mm

All specifications subject to change without notice

Type of heating	POWER SUPPLY - FUSES	
	220V 3AC	380V (tri + N)
Boiler Fed	16 A	16 A
Steam heating	16 A	16 A
Electrical heating 4.2kW	16 A	16 A
Electrical heating 6kW	16 A	16 A
Electrical heating 9kW	25 A	16 A



IPSO

IPSO LSG n.v.
 Nieuwstraat 146
 B-8560 WEVELGEM
 BELGIUM – EUROPE
 Phone ++32 56 41 20 54
 Fax ++32 56 41 86 74
<http://www.ipso.be>

* Standard 60°C program without prewash – 6 kW heating - frequency controlled motor

-an LSG company



Freestanding washing machine
Capacity 7.3 kg. (1/10)
High spin 500 to 1000 rpm
Standard frequency inverter controlled
Microprocessor with 10 programs Micro-20
Or
Programmable Microprocessor PS 40

HW72

Boiler Fed	
Electrical heating	4.2-6-9 kW (220 V) 4.2-6-9-12 kW (380 V)
Steam heating	
	Consumption 7.2 kg./cycle

IPSO HW72

Volume drum 73 l.
 High spin 1000 rpm
 Safety unbalance detection with controlled repetition
 Micro-20 controls with 10 standard washing programs.
 Optional : Freely programmable computer PS 40
 10 standard washing programs + 40 freely programmable programs
 Gravity drain valve with large diameter
 3 inlet valves (hot soft/cold soft/hard water)
 2 soap compartments + 1 softner compartment on top
 Frontal loading
 Electro-magnetical locking device for the door
 Door opening : 300 mm
 Tub, cylinder and cabinet are made of stainless steel
 Emergency button in the front
 Dimensions (HxWxD) :1005x660x730 mm.

Micro-20 Microprocessor

10 standard programs, preprogrammed at IPSO.
 Possibility to add on programs up to 100 programs.
 Standard frequency controlled motor and with the optional soap pumps, it is possible to programme the following parameters :

- Cycle time (Prewash, mainwash, rinse, spin, tumble...)
- Rotation and stop speeds programmable from 0,1 till 60s
- Water level programmable per cm.
- Control of 2 drain valves (second valve in option) with possibility to recycle rinse water.
- Connection up to 6 pumps controlled by Micro-20

Programmable Microprocessor PS40

Possibility to compose 40 programs + 10 standard programs, preprogrammed at IPSO.
 Programs immediately programmable on the machine or with the computer.
 Programs transmissible from computer to machine and the other way around with infra-red cable connection.
 In combination with the frequency controlled motor and the soap pumps (option), it is possible to programme the following parameters :

- Cycle time (Prewash, mainwash, rinse, spin, tumble...)
- Rotation and stop speeds programmable from 0,1 till 60s
- Water level programmable per cm.
- Control of 2 drain valves (second valve in option) with possibility to recycle rinse water.
- Connection up to 12 pumps controlled by PS40



for 60 Hz only



IPSO

- an LSG company

IPSO HW72

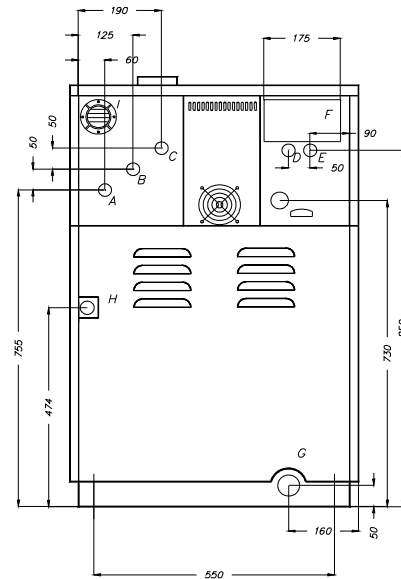
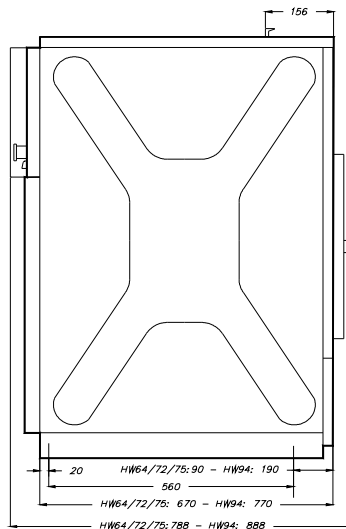
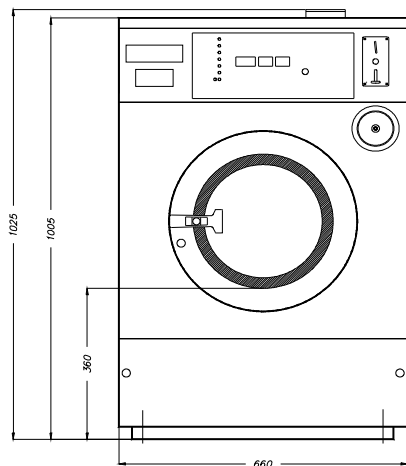

- A. Soft water connection 3/4"
- B. Warm water connection 3/4"
- C. Hard water connection 3/4"

- D. Electrical connection
- E. Electrical connection clamps
- G. Drain valve
- H. Steam connection

Cylinder : Volume	73L
Diameter	530 mm
Depth	330 mm
Perforations diam	3 mm
Door opening diam	300 mm
Height to door handle	505 mm
Speed : High spin	500-1000 rpm
Low spin	250-500 rpm
Distribution	85 rpm
Wash	10-50 rpm
G-force	74/296
Kinetic energy of the cylinder	1386 N/m
Dynamic bottom load	700 N / 16Hz

Energy consumption (mot/heating)*	0.15 / 1.5 kW
Power motor	750W
Water pressure	3 to 5 bars
Hot water T° (boiler fed)	80°C
Max. water consumption	80 L
Warm water need (boiler fed machine)	65L/cycle
Diam. drain	50 mm
Drain by gravity	80L/min .
Steam pressure	6 to 10 kg.
Weight gross /nett	225/203 kg.
Packing dimensions Height	1140 mm
Width	740 mm
Depth	840 mm

All specifications subject to change without notice

Type of heating	POWER SUPPLY - FUSES	
	220V 3AC	380V (tri + N)
Boiler Fed	16 A	16 A
Steam heating	16 A	16 A
Electrical heating 4.2kW	16 A	16 A
Electrical heating 6kW	16 A	16 A
Electrical heating 9kW	25 A	16 A
Electrical heating 12kW	40 A	20 A

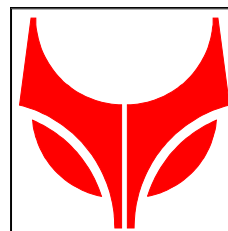

IPSO
- an LSG company

IPSO LSG n.v.
Nieuwstraat 146
B-8560 WEVELGEM
BELGIUM – EUROPE
Phone ++ 32 56 41 20 54
Fax ++ 32 56 41 86 74
<http://www.ipso.be>



* Standard 60°C program without prewash – 6 kW heating – frequency controlled motor



Freestanding washing machine
Capacity 9.5 kg. (1/10)
High spin 500 to 1000 rpm
Standard frequency inverter controlled
Microprocessor with 10 programs Micro-20
Or
Programmable Microprocessor PS 40

HW94

Boiler Fed	
Electrical heating	4.2-6-9 kW (220 V) 4.2-6-9-12 kW (380 V)
Steam heating	
	Consumption 9.5 kg./cycle

IPSO HW94

Volume drum 95 l.
 High spin 1000 rpm
 Safety unbalance detection with controlled repetition
 Micro-20 controls with 10 standard washing programs.
 Optional : Freely programmable computer PS 40
 10 standard washing programs + 40 freely programmable programs
 Gravity drain valve with large diameter
 3 inlet valves (hot soft/cold soft/hard water)
 2 soap compartments + 1 softener compartment on top
 Frontal loading
 Electro-magnetical locking device for the door
 Door opening : 300 mm
 Tub, cylinder and cabinet are made of stainless steel
 Emergency button in the front
 Dimensions (HxWxD) :1005x660x830 mm.

Micro-20 Microprocessor

10 standard programs, preprogrammed at IPSO.
 Possibility to add on programs up to 100 programs.
 Standard frequency controlled motor and with the optional soap pumps, it is possible to programme the following parameters :

- Cycle time (Prewash, mainwash, rinse, spin, tumble...)
- Rotation and stop speeds programmable from 0,1 till 60s
- Water level programmable per cm.
- Control of 2 drain valves (second valve in option) with possibility to recycle rinse water.
- Connection up to 6 pumps controlled by Micro-20

Programmable Microprocessor PS40

Possibility to compose 40 programs + 10 standard programs, preprogrammed at IPSO.
 Programs immediately programmable on the machine or with the computer.
 Programs transmissible from computer to machine and the other way around with infra-red cable connection.
 In combination with the frequency controlled motor and the soap pumps (option), it is possible to programme the following parameters :

- Cycle time (Prewash, mainwash, rinse, spin, tumble...)
- Rotation and stop speeds programmable from 0,1 till 60s
- Water level programmable per cm.
- Control of 2 drain valves (second valve in option) with possibility to recycle rinse water.
- Connection up to 12 pumps controlled by PS40



for 60 Hz only



IPSO

- an LSG company

IPSO HW94

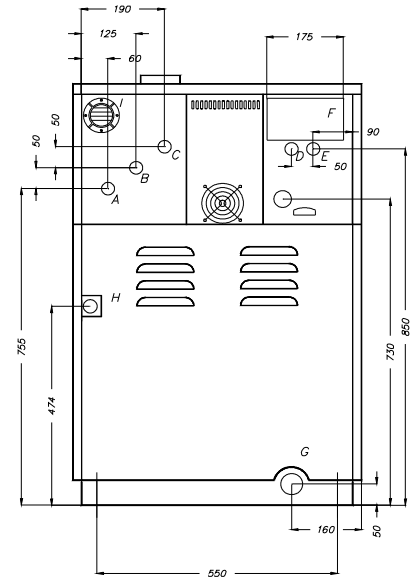
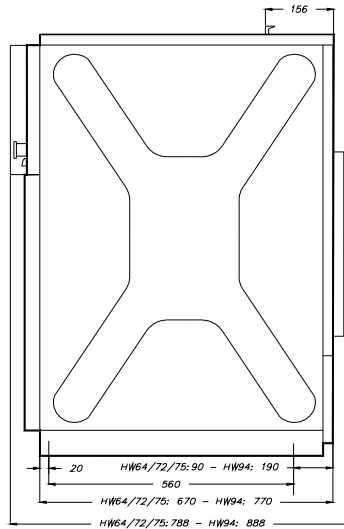
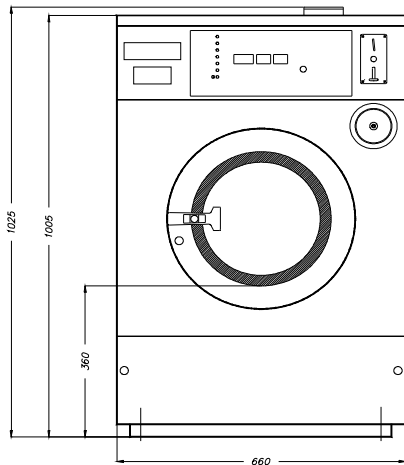

- A. Soft water connection 3/4"
- B. Warm water connection 3/4"
- C. Hard water connection 3/4"

- D. Electrical connection
- E. Electrical connection clamps
- G. Drain valve
- H. Steam connection

Cylinder : Volume	95L
Diameter	530 mm
Depth	440 mm
Perforations diam	3 mm
Door opening diam	300 mm
Height to door handle	505 mm
Speed : High spin	500-1000 rpm
Low spin	250-500 rpm
Distribution	85 rpm
Wash	10-50 rpm
G-force	74/296
Kinetic energy of the cylinder	1730 N
Dynamic bottom load	750 N / 16 Hz

Energy Consumption (mot/heating)*	0.15 / 2.25 kW
Power motor	750W
Water pressure	3 to 5 bars
Hot water T° (boiler fed)	80°C
Max. water consumption	110 L
Warm water need (boiler fed machine)	80L/cycle
Diam. drain	50 mm
Drain by gravity	80L/min .
Steam pressure	6 to 10 kg.
Weight gross /nett	230/208 kg.
Packing dimensions	Height 1250 mm
	Width 740 mm
	Depth 950 mm

All specifications subject to change without notice

Type of heating	POWER SUPPLY - FUSES	
	220V 3AC	380V (tri + N)
Boiler Fed	16 A	16 A
Steam heating	16 A	16 A
Electrical heating 4.2kW	16 A	16 A
Electrical heating 6kW	16 A	16 A
Electrical heating 9kW	25 A	16 A
Electrical heating 12kW	40 A	20 A



IPSO

IPSO LSG n.v.
 Nieuwstraat 146
 B-8560 WEVELGEM
 BELGIUM – EUROPE
 Phone ++ 32 56 41 20 54
 Fax ++ 32 56 41 86 74
<http://www.ipso.be>



* Standard 60°C program without prewash – 9 kW heating - frequency controlled - an LSG company



Freestanding washing machine
Capacity 13.2 kg. (1/10)
High spin 500 to 1000 rpm
Standard frequency inverter controlled
Microprocessor with 10 programs Micro-20
Or
Programmable Microprocessor PS 40

HW131

Boiler Fed	
Electrical heating	12-15-18 kW (220 V) 12-15-21-24 kW (380 V)
Steam heating	
	Consumption 13.2 kg./cycle

IPSO HW131

Volume drum 132 l.
 High spin 1000 rpm
 Safety unbalance detection with controlled repetition
 Micro-20 controls with 10 standard washing programs.
 Optional : Freely programmable computer PS 40
 10 standard washing programs + 40 freely programmable programs
 Gravity drain valve with large diameter
 3 inlet valves (hot soft/cold soft/hard water)
 2 soap compartments + 1 softner compartment on top
 Frontal loading
 Electro-magnetical locking device for the door
 Door opening : 300 mm
 Tub, cylinder and cabinet are made of stainless steel
 Emergency button in the front
 Dimensions (HxWxD) :1170x780x760 mm.

Micro-20 Microprocessor

10 standard programs, preprogrammed at IPSO.
 Possibility to add on programs up to 100 programs.
 Standard frequency controlled motor and with the optional soap pumps, it is possible to programme the following parameters :

- Cycle time (Prewash, mainwash, rinse, spin, tumble...)
- Rotation and stop speeds programmable from 0,1 till 60s
- Water level programmable per cm.
- Control of 2 drain valves (second valve in option) with possibility to recycle rinse water.
- Connection up to 6 pumps controlled by Micro-20

Programmable Microprocessor PS40

Possibility to compose 40 programs + 10 standard programs, preprogrammed at IPSO.
 Programs immediately programmable on the machine or with the computer.
 Programs transmissible from computer to machine and the other way around with infra-red cable connection.
 In combination with the frequency controlled motor and the soap pumps (option), it is possible to programme the following parameters :

- Cycle time (Prewash, mainwash, rinse, spin, tumble...)
- Rotation and stop speeds programmable from 0,1 till 60s
- Water level programmable per cm.
- Control of 2 drain valves (second valve in option) with possibility to recycle rinse water.
- Connection up to 12 pumps controlled by PS40



for 60 Hz only



IPSO

- an LSG company

IPSO HW131

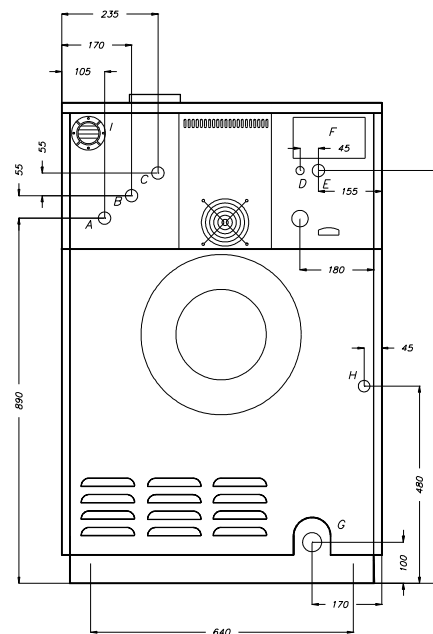
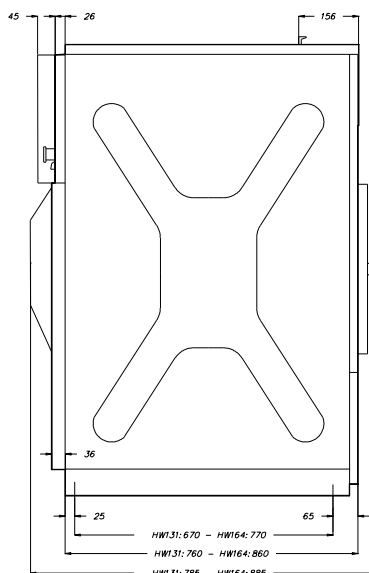
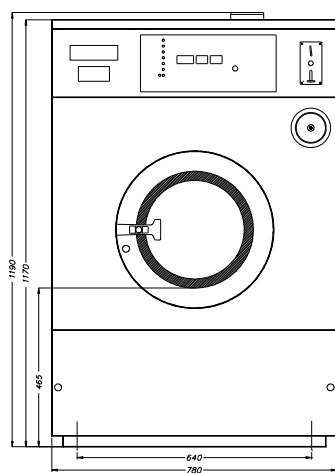

- A. Soft water connection 3/4"
- B. Warm water connection 3/4"
- C. Hard water connection 3/4"
- D. Electrical connection

- E. Electrical connection clamps
- G. Drain valve
- H. Steam connection
- I. Ventilation

Cylinder : Volume	132L
Diameter	650 mm
Depth	400 mm
Perforations diam	3 mm
Door opening diam	300 mm
Height to door handle	605 mm
Speed : High spin	500-1000 rpm
Low spin	250-500 rpm
Distribution	85 rpm
Wash	10-50 rpm
G-force	88/363
Kinetic energy of the cylinder	2592 N/m
Dynamic bottom load	1000 N / 16 Hz

Energy consumption (mot/heating)*	0.2 / 3 kW
Power motor	1500W
Water pressure	3 to 5 bars
Hot water T° (boiler fed)	80°C
Max. water consumption	150 L
Warm water need (boiler fed machine)	100L/cycle
Diam. drain	50 mm
Drain by gravity	80L/min .
Steam pressure	6 to 10 kg.
Weight gross /nett	317 /287kg.
Packing dimensions Height	1310 mm
Width	850 mm
Depth	940 mm

Type of heating	POWER SUPPLY - FUSES	
	220V 3AC	380V (tri + N)
Boiler Fed	16 A	16 A
Steam heating	16 A	16 A
Electrical heating 12kW	40 A	20 A
Electrical heating 15kW	50 A	25 A
Electrical heating 18kW	50 A	32 A
Electrical heating 21kW	---	40 A
Electrical heating 24kW	---	40 A

All specifications subject to change without notice

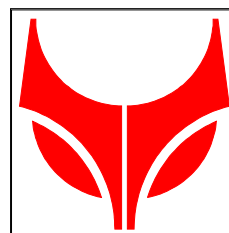

IPSO

- an LSG company

IPSO LSG n.v.
 Nieuwstraat 146
 B-8560 WEVELGEM
 BELGIUM – EUROPE
 Phone ++32 56 41 20 54
 Fax ++32 56 41 86 74
<http://www.ipso.be>



* Standard 60°C program without prewash – 12 kW heating - frequency controlled motor



Freestanding washing machine
Capacity 16.5 kg. (1/10)
High spin 500 to 1000 rpm
Standard frequency inverter controlled
Microprocessor with 10 programs Micro-20
Or
Programmable Microprocessor PS 40

HW164

Boiler Fed	
Electrical heating	12-15-18 kW (220 V) 12-15-18-21-24 kW (380 V)
Steam heating	
	Consumption 16.5 kg./cycle

Volume drum 165 l.
 High spin 1000 rpm
 Safety unbalance detection with controlled repetition
 Micro-20 controls with 10 standard washing programs.
 Optional : Freely programmable computer PS 40
 10 standard washing programs + 40 freely programmable programs
 Gravity drain valve with large diameter
 3 inlet valves (hot soft/cold soft/hard water)
 2 soap compartments + 1 softener compartment on top
 Frontal loading
 Electro-magnetical locking device for the door
 Door opening : 300 mm
 Tub, cylinder and cabinet are made of stainless steel
 Emergency button in the front
 Dimensions (HxWxD) :1170x780x865 mm.

Micro-20 Microprocessor

10 standard programs, preprogrammed at IPSO.
 Possibility to add on programs up to 100 programs.
 Standard frequency controlled motor and with the optional soap pumps, it is possible to programme the following parameters :

- Cycle time (Prewash, mainwash, rinse, spin, tumble...)
- Rotation and stop speeds programmable from 0,1 till 60s
- Water level programmable per cm.
- Control of 2 drain valves (second valve in option) with possibility to recycle rinse water.
- Connection up to 6 pumps controlled by Micro-20

Programmable Microprocessor PS40

Possibility to compose 40 programs + 10 standard programs, preprogrammed at IPSO.
 Programs immediately programmable on the machine or with the computer.
 Programs transmissible from computer to machine and the other way around with infra-red cable connection.
 In combination with the frequency controlled motor and the soap pumps (option), it is possible to programme the following parameters :

- Cycle time (Prewash, mainwash, rinse, spin, tumble...)
- Rotation and stop speeds programmable from 0,1 till 60s
- Water level programmable per cm.
- Control of 2 drain valves (second valve in option) with possibility to recycle rinse water.
- Connection up to 12 pumps controlled by PS40



for 60 Hz only



IPSO

- an LSG company

IPSO HW164

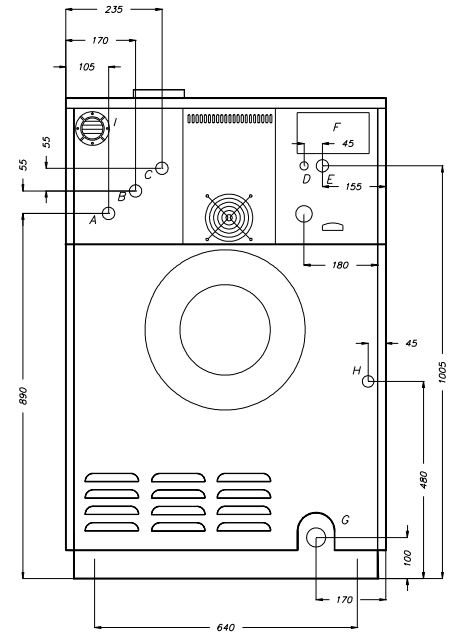
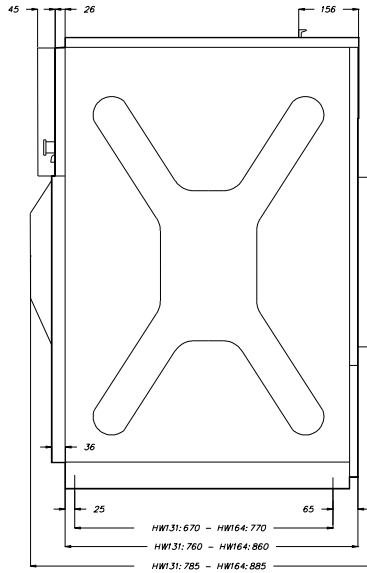
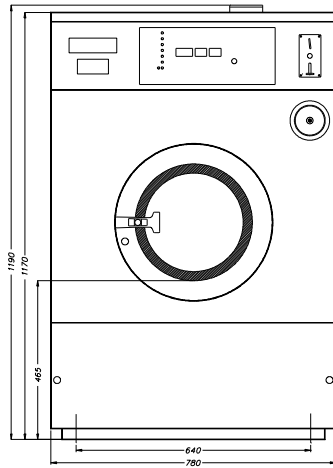

- A. Soft water connection 3/4"
- B. Warm water connection 3/4"
- C. Hard water connection 3/4"
- D. Electrical connection

- E. Electrical connection clamps
- G. Drain valve
- H. Steam connection
- I. Ventilation

Cylinder : Volume	164L
Diameter	650 mm
Depth	500 mm
Perforations diam	3 mm
Door opening diam	300 mm
Height to door handle	605 mm
Speed : High spin	500-1000 rpm
Low spin	250-500 rpm
Distribution	85 rpm
Wash	10-50 rpm
G-force	88/363
Kinetic energy of the cylinder	3240 N
Dynamic bottom load	1200 N / 16 Hz

Energy consumption (mot/heating)*	0.2 / 3.75 kW
Power motor	1500W
Water pressure	3 to 5 bars
Hot water T° (boiler fed)	80°C
Max. water consumption	185 L
Warm water need (boiler fed machine)	120L/cycle
Diam. drain	50 mm
Drain by gravity	80L/min .
Steam pressure	6 to 10 kg.
Weight gross /nett	377/347 kg.
Packing dimensions Height	1310 mm
Width	850 mm
Depth	1080 mm

Type of heating	POWER SUPPLY - FUSES	
	220V 3AC	380V (tri + N)
Boiler Fed	16 A	16 A
Steam heating	16 A	16 A
Electrical heating 12kW	40 A	20 A
Electrical heating 15kW	50 A	25 A
Electrical heating 18kW	50 A	32 A
Electrical heating 21kW	---	40 A
Electrical heating 24kW	---	40 A



IPSO
- an LSG company

IPSO LSG n.v.
Nieuwstraat 146
B-8560 WEVELGEM
BELGIUM – EUROPE
Phone ++32 56 41 20 54
Fax ++32 56 41 86 74
<http://www.ipso.be>



All specifications subject to change without notice